

Smoke Detector, Carbon Monoxide Detector, and Fire Extinguisher Information

All inspections MUST comply with the current Township and State laws governing smoke detectors, carbon monoxide detectors and fire extinguishers.

Note: **ALL battery-operated detectors must be of a 10-year sealed battery type.**

ALL existing Hardwired systems must be maintained.

Smoke Detector installation requirements may vary due to construction year and retrofit requirements.

WHERE TO LOCATE SMOKE DETECTORS:

UL approved detectors are to be located on every level of a residence (basement, 1st floor, 2nd floor, etc.) **excluding crawl spaces and unfinished attic areas with pull down type stairs.** They can be 10-year sealed battery-operated or electric. All Smoke Detectors shall be located on the ceiling and within 10 feet of every bedroom. If there are no bedrooms on a level, then they must be placed within 10 feet of the stairway on that particular level. **PHOTOELECTRIC** type smoke detectors are to be installed if any of the installation areas are within 10 feet of a kitchen area.

NOTE: Smoke detectors are to be permanently affixed to ceiling areas with manufacturer-provided screws. Under no circumstances are they to be installed with double-stick tape or Velcro. They must be less than 10 years old unless otherwise recommended by the manufacturer. It will be the owners responsibility to check the detectors age and operability prior to the inspection.

CENTRAL STATION FIRE ALARMS: Central station fire alarms shall be tested prior to the inspection. The fire alarm test record must be from a Division of Fire Safety certified fire alarm company and shall be given to the fire inspector at the time of the inspection. Fairfield Fire Inspectors **WILL NOT** test central station fire alarms. If no report is available, the inspection **WILL FAIL!**

WHERE NOT TO LOCATE SMOKE DETECTORS:

To avoid false alarms and/or improper operation, do not place detectors in the following areas:

- Kitchens- unless it has bedrooms located directly off of the Kitchen then a PHOTOELECTRIC detector is required.
- Bathrooms- excessive steam from a shower may cause a nuisance alarm.
- Near forced air ducts used for heating or air conditioning- air movement may prevent smoke from reaching detector.
- Near furnaces of any type- air and dust movement and normal combustion products may cause a nuisance alarm.
- The peak of an “A” frame type of ceiling- “Dead Air” at the top may prevent smoke from reaching detector.

CARBON MONOXIDE DETECTORS:

Alarms may be battery-operated or electric and listed according to UL 2034, and must be dated accordingly and installed within 10 feet of all sleeping areas as per manufacturer's instructions and NFPA-720. If there are sleeping areas on more than one floor additional CO detectors will be required. *CO Detector Symbol* ☀

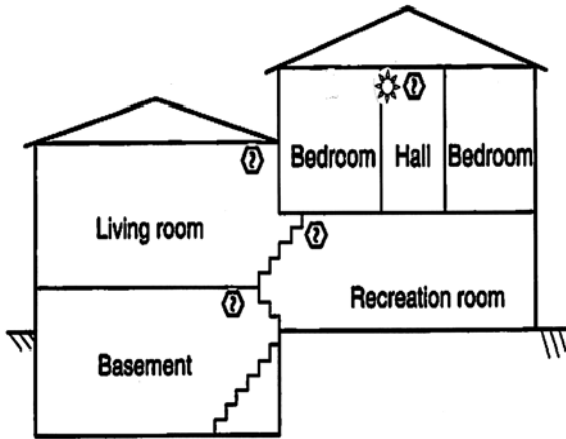

☀ Indicates required smoke alarm

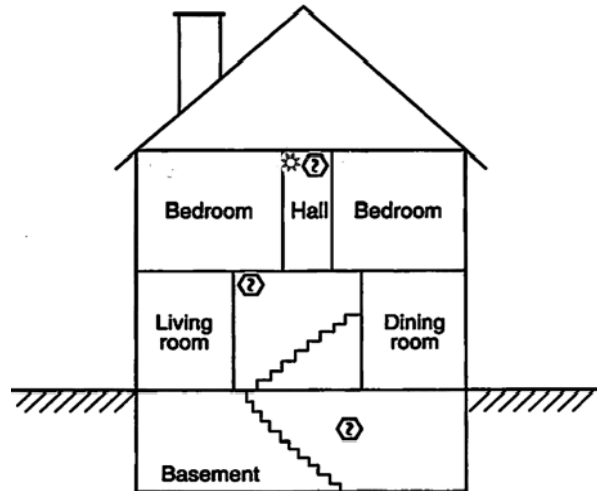
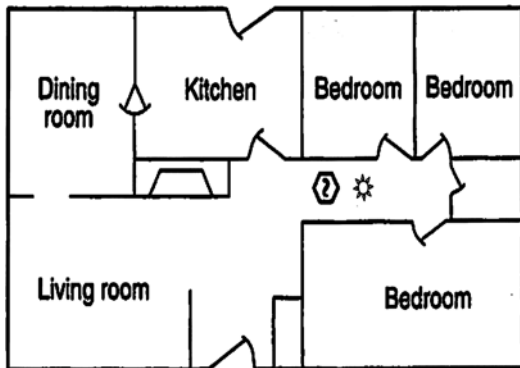
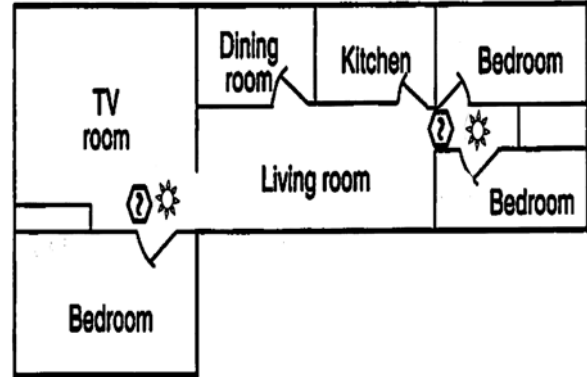

FIRE EXTINGUISHERS:

- At least one (1) portable fire extinguisher shall be installed in all kitchens or within 10 feet of the stove and located in the path of egress to the exterior.
- It shall have a minimum rating of **2A-10B:C** and no more than 10 pounds.
- It shall be listed, labeled, charged, and operable.
- It must be *mounted* in a bracket or hanger supplied by the manufacturer, hung in a visible, readily accessible spot, free from blocking by furniture, storage, equipment, and other items. The top of the extinguisher shall be mounted no higher than five (5') above the floor.
- The owner's manual or written operation instructions shall be provided during the inspection and left for the new occupant.
- The extinguisher shall be serviced and tagged by a certified Division of Fire Safety contractor within the past 12 months or have a recently purchased receipt.